

**REVISIONS:**

NO.	REVISION	DATE

**Construction Notes:**

- All construction shall conform to the Ontario Building Code.
- All doors and windows sizes shall be confirmed & approved by owner or contractor prior to construction.
- Contractor shall verify all conditions and dimensions prior to construction and be solely responsible for any changes necessary as a result of conditional or dimensional differences.
- Verify all dimensions on site.
- All dimensions are taken from the exterior face of wood framing or outside of concrete.
- Any substitution of materials or spans shall conform to the Ontario Building Code.
- Install floor joists or wood blocking under non-loadbearing walls that run parallel to floor joist.
- Provide solid wood blocking under all point loads.
- Concrete foundations walls and footings shall have a compressive strength of 15MPa after 28 days.
- Unreinforced concrete garage and floors and all flat work shall have a compressive strength of 32 MPa after 28 days
- Stair dimensions shall conform to D.B.C. 98.3.1) & Table 98.3.1
- Rise= 7 7/8"
- Run= 14"
- Tread Depth = 14"
- Guardrails for all stairs and decks shall conform to D.B.C. 918 & 919-7
- Stairwell headroom in a dwelling unit shall be min. 6'-5" measured vertically conform to D.B.C. 98.3.4.1) 14. Carbon Monoxide detectors within dwelling units shall conform to D.B.C. 9.33.4.2.(1),(2),(a),(b),(2),(3).
- All smoke alarms within dwelling units shall conform to D.B.C. 9.10.18.4.(1)
- All Electrical equipment & facilities within dwelling units shall conform to D.B.C. 9.34.1.2.(1)

DOOR SCHEDULE				
MARK	SIZE			NOTES
	W/D	HGT	THK	
01	2'-10"	6'-8"	1 3/4"	Sliding Insulated Exterior Insulated
02	6'-0"	6'-8"	1 1/4"	Sliding Patio Drs. w/security latch
03	2'-4"	6'-8"	1 3/8"	Interior Door
04	2'-6"	6'-8"	1 3/8"	Interior Door
05	2'-8"	6'-8"	1 3/8"	Interior Door
06	2'-4"	6'-8"	1 3/8"	Interior Pocket Door

**WOOD FRAMING**

- ALL FRAMING LUMBER TO O.B.C. STANDARDS SIZES OF JOISTS, LINTELS, ETC. UNDRATED LUMBER. SPECIFIED AS PER NO. 2 SPT. (UNLESS OTHERWISE NOTED).
- B.U. WOOD BEAMS TO HAVE MIN. 89MM ( 3 1/2") BEARING
- LATERAL SUPPORT - (WALLS SUPPORTING JOISTS) - ANCHOR SILL PLATE AT 2400mm ( 8'-0") o.c. WITH 13mm ( 1/2") DIA. ANCHOR BOLTS EMBEDDED 100mm ( 4") INTO CONCRETE OR ANCHORED EVERY 4TH JOIST NOT RESTING ON A PLATE WITH 4.8mm X 38mm STEEL JOIST ANCHORS N.B.
- LATERAL SUPPORT - (WALLS PARALLEL TO JOISTS) - BEND 4.8mm X 38mm ( 3/16" x 1 1/2") STEEL STRAP 75mm ( 3") INTO CONCRETE AND FIX TO 3 PARALLEL JOISTS OR FIX SILL PLATE ( ANCHORED ) TO 3 RIGIDLY CONNECTED FLOOR JOISTS AT 2030mm ( 6'-8") o.c. (MAX.)
- ALL JOISTS TO HAVE BRIDGING OVER INTERIOR BEARING WALLS AND BEAMS.
- MIN. SILL PLATE 38mm X 89mm ( 2" x 4").
- PROVIDE CROSS-BRIDGING BETWEEN JOISTS WITH MAXIMUM SPACING OF 1200mm ( 4'-0").
- HEADER JOISTS TO BE DOUBLED IF OVER 1200mm ( 4'-0") AND NOT OVER 3200mm ( 10'-6").
- TRIMMER JOISTS TO BE DOUBLE IF OVER 800mm ( 2'-8") AND NOT OVER 2400 mm ( 8'-0") o.c.
- DOUBLE JOISTS UNDER ALL PARALLEL PARTITIONS.
- MIN. 38mm ( 2") END BEARING REQUIRED FOR SUPPORT FOR JOISTS, CEILING JOISTS, ROOF JOISTS AND RAFTERS.
- PROVIDE METAL JOISTS HANGERS FOR SUPPORT OF JOISTS FRAMING INTO SIDES OF WOOD BEAMS, TRIMMER AND HEADERS WHERE REQUIRED.
- ALL CONCEALED SPACES TO BE FIRE STOPPED BETWEEN STORES AT FLOORS, CEILING, ROOFS, AND AT STAIRS.
- WOOD STUD PARTITIONS TO BE MADE UP OF 38mm X 89mm ( 2"x4") SPT 400 ( 16") o.c. AND 38mm X 89mm ( 2"x4") TOP AND BOTTOM PLATES. DOUBLE TOP STUDS AROUND OPENINGS AND TRIPLE STUDS IN CORNERS IN BEARING STUD PARTITIONS.

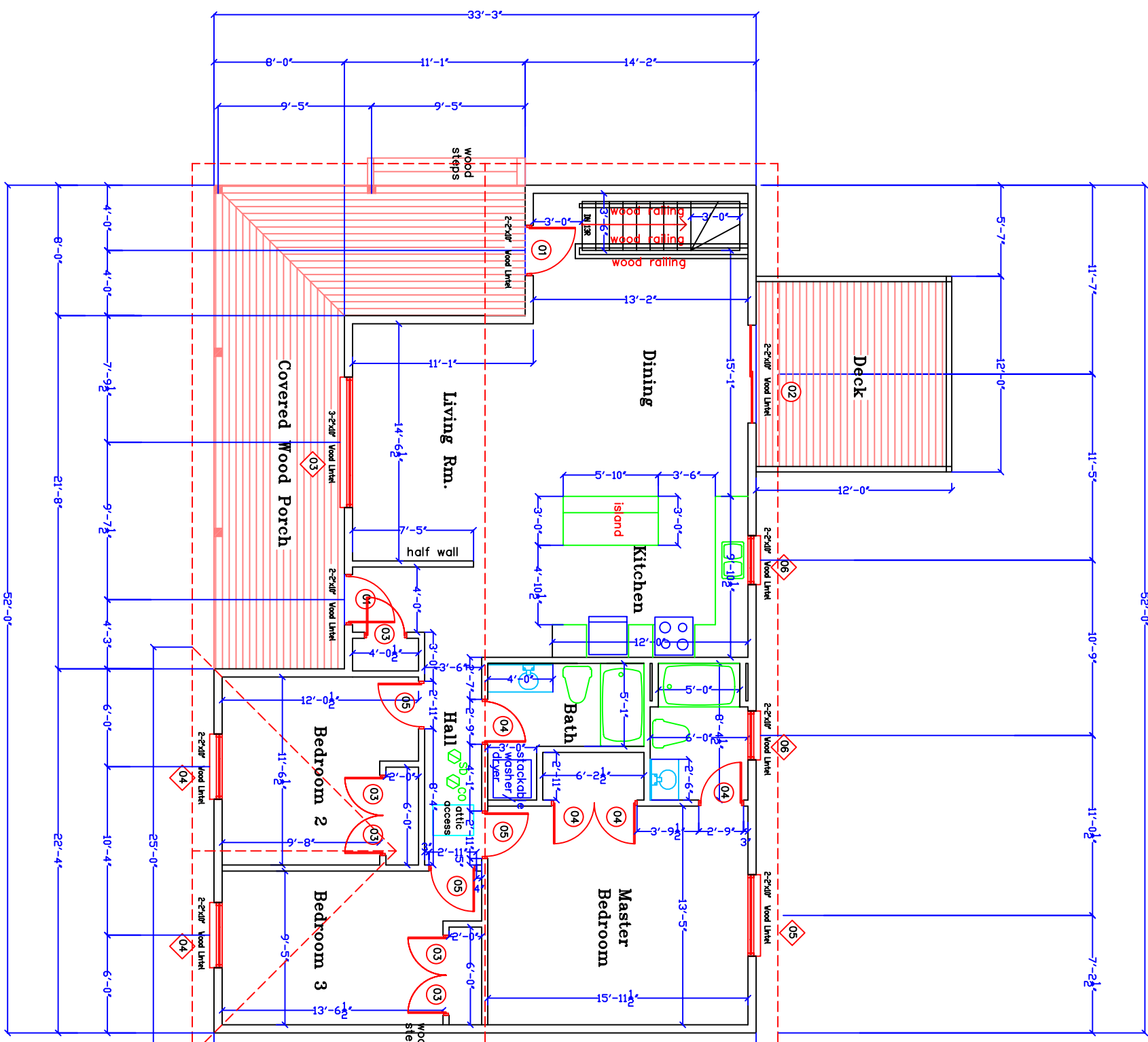

WINDOW SCHEDULE			
MARK	SIZE		TYPE
	WIDTH	HEIGHT	
1	3'-11"	2'-8"	Glider
2	3'-11"	2'-8"	Glider
3	6'-0"	5'-0"	Casement 1 operator
4	4'-0"	4'-6"	Casement 1 operator
5	6'-0"	3'-6"	Casement 1 operator
6	3'-0"	3'-0"	Casement 1 operator

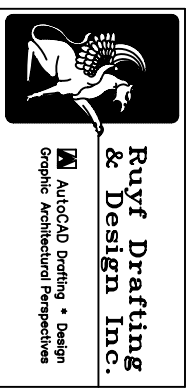

Project: **1403 sq. ft. Bungalow**  
Client: **ROBINSON CUSTOM HOMES**

Drawing Title: **MAIN FLOOR PLAN**

Scale: **1/8" = 1'-0"**  
Date: **NOVEMBER, 2012**

Drawn By: **G. RUYF**  
Checked By: **G. RUYF**  
Approved By: **G. RUYF**

**A2** of **5**

**MAIN FLOOR PLAN**  
1403 SQUARE FEET